

Ashwell Grange,  
Stroat,  
Chepstow  
Monmouthshire  
NP16 7LS  
Tel (01594) 528224  
Fax (01594) 528211  
[www.reecer.co.uk](http://www.reecer.co.uk)  
email [info@reecer.co.uk](mailto:info@reecer.co.uk)

**Specialist Dealers in the Sale & Purchase of all Portable Buildings and Containers**  
Transport • Storage • Site Work • Refurbishment



## RS 1078

24' x 9' PLASTISOL STEEL JACKLEG PARTITIONED OFFICE

Partitioned to form open plan office with separate kitchen.  
Convactor heating, fluorescent lighting and vinyl flooring throughout.

**£2295.00 + VAT 'as is'**

# Unit Information

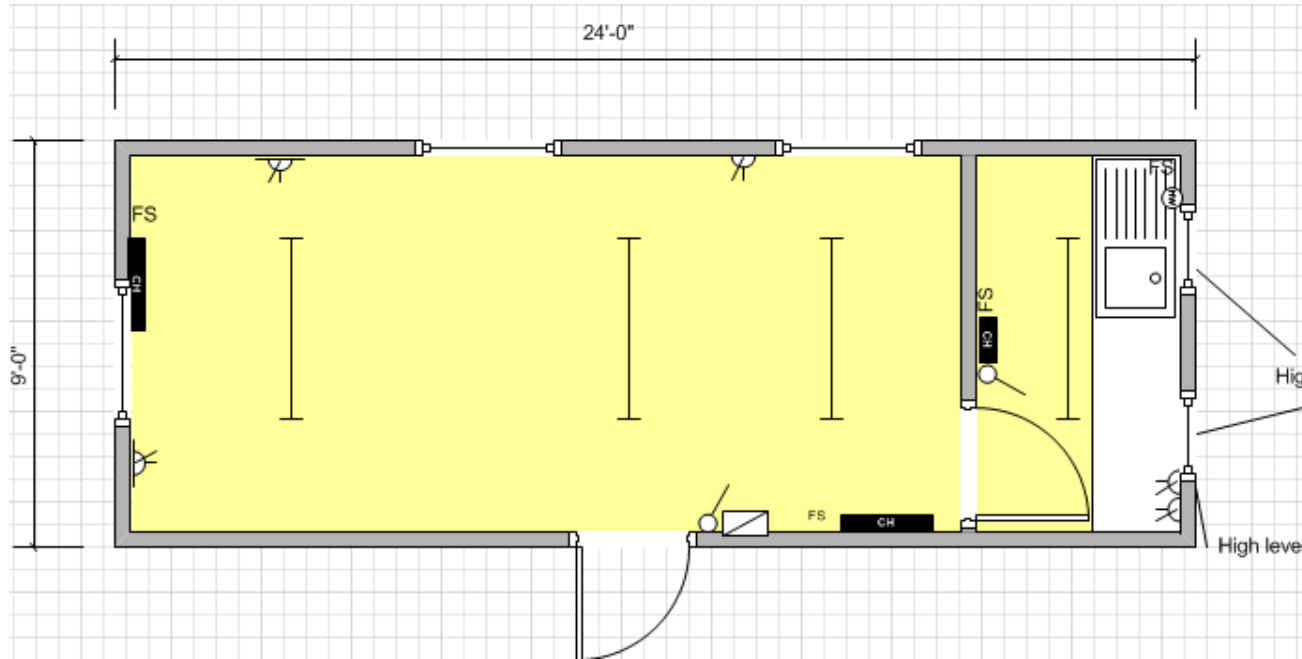

| Key |                      |  |                        |
|-----|----------------------|--|------------------------|
|     | Carpet Tiles         |  | Vinyl Flooring         |
|     | Fluorescent Light    |  | Cat 2 Light            |
|     | Consumer Unit        |  | Light Switch           |
|     | Water Heater         |  | Bulkhead Light         |
|     | Single Switch Socket |  | Double Switch Socket   |
|     | Convactor Heater     |  | Guarded Tubular Heater |
|     | Fan Heater           |  | Fused Spur             |
|     | Kitchen Sink         |  | Worktop                |
|     | Double Sink          |  | Urinal                 |
|     | Hand Basin           |  | Toilet                 |
|     | Door                 |  | Aperture               |
|     | Window               |  | Jackleg                |

## Specification:

**Doors:** 1 no external steel

**Heating:** 3 No. convactor heaters

**Other Information:**

**Windows:** 3 No. 3' windows in office. 2 No. 2' High level windows in kitchen area

**Floor Coverings:** Vinyl

**Lighting:** 4 No. Fluorescent Lights

**Wall Coverings:** Plastic coated steel

**Power:** 5 No. Double sockets

**Ceiling Coverings:** White vinyl faced ply