

## **RS 1081 28' x 28' MODULAR OFFICE WITH STORE**

28' x 28' partitioned modular to form separate storage room with racking and vinyl flooring, lobby area and large open plan office space with carpet flooring. Heating, lighting throughout.

**£14995.00 + VAT Strictly "as is"**

## Unit Information

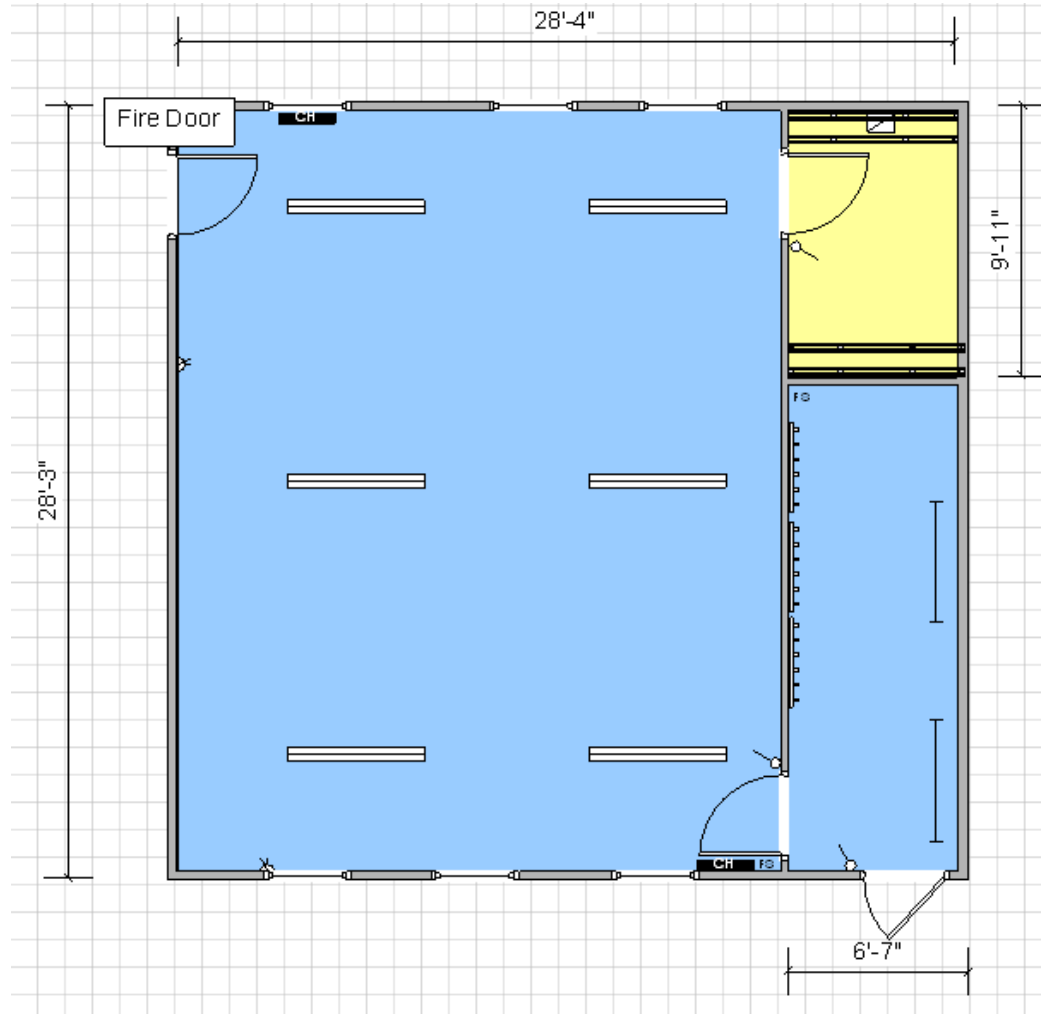

## Key

	Carpet Tiles		Vinyl Flooring
	Florescent Light		Cat 2 Light
	Consumer Unit		Light Switch
	Water Heater		Bulkhead Light
	Single Switch Socket		Double Switch Socket
	Convector Heater		Guarded Tubular Heater
	Fan Heater		Fused Spur
	Kitchen Sink		Worktop
	Double Sink		Urinal
	Hand Basin		Toilet
	Door		Aperture
	Window		Jackleg

## Specification:

**Doors:** 1 No. External door  
1 No. Fire door  
2 No. Internal doors

**Windows:** 6 No. 3' Windows in office.

**Lighting:** 2 No. Florescent Lights  
6 No. Cat 2

**Power:** 3 No. Double Sockets

**Heating:** 2 No. Convector Heaters

**Floor Coverings:** Carpet Tiles and Vinyl flooring in store room

**Wall Coverings:** Plasterboard

**Ceiling Coverings:** Plasterboard

**Other Information:**