

Ashwell Grange,
Stroat,
Chepstow
Monmouthshire
NP16 7LS
Tel (01594) 528224
Fax (01594) 528211
www.reecer.co.uk
email info@reecer.co.uk

Specialist Dealers in the Sale & Purchase of all Portable Buildings and Containers
Transport • Storage • Site Work • Refurbishment



RS 1096

50' x 20' partitioned to form four open plan office with separate kitchen and disabled toilet facilities. Heating, lighting and mainly carpet tile flooring.

£10,995.00 + VAT Strictly "as is"

Unit Information

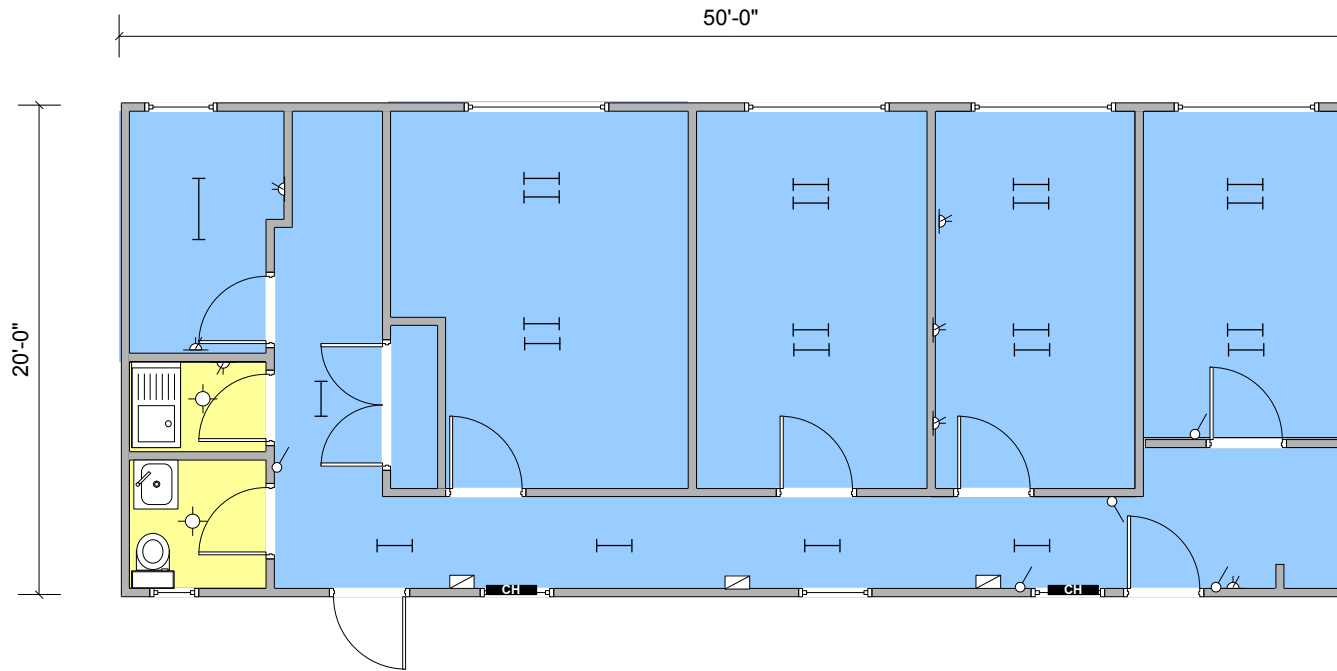

Key			
	Carpet Tiles		Vinyl Flooring
	Florescent Light		Cat 2 Light
	Consumer Unit		Light Switch
	Water Heater		Bulkhead Light
	Single Switch Socket		Double Switch Socket
	Convactor Heater		Guarded Tubular Heater
	Fan Heater		Fused Spur
	Kitchen Sink		Worktop
	Double Sink		Urinal
	Hand Basin		Toilet
	Door		Aperture
	Window		Jackleg

Specification:

Doors: 2 no external wood doors

Heating: Gas radiators

Other Information:

Windows: 3 No. 180 x 90 No. 2' High level windows in kitchen area

Floor Coverings: Mostly carpet

Lighting: 4 No. Fluorescent Lights

Wall Coverings: Plastic coated steel

Power: 5 No. Double sockets

Ceiling Coverings: White vinyl faced ply