



Ashwell Grange,
Stroat,
Chepstow
Monmouthshire
NP16 7LS
Tel (01594) 528224
Fax (01594) 528211
www.reecer.co.uk
email info@reecer.co.uk

Specialist Dealers in the Sale & Purchase of all Portable Buildings and Containers
Transport • Storage • Site Work • Refurbishment



RS 1333

12'6" x 8'6" JACKLEG

Open plan office internally consisting of vinyl flooring, convector heating and fluorescent lighting.

£1595.00 + VAT

Unit Information

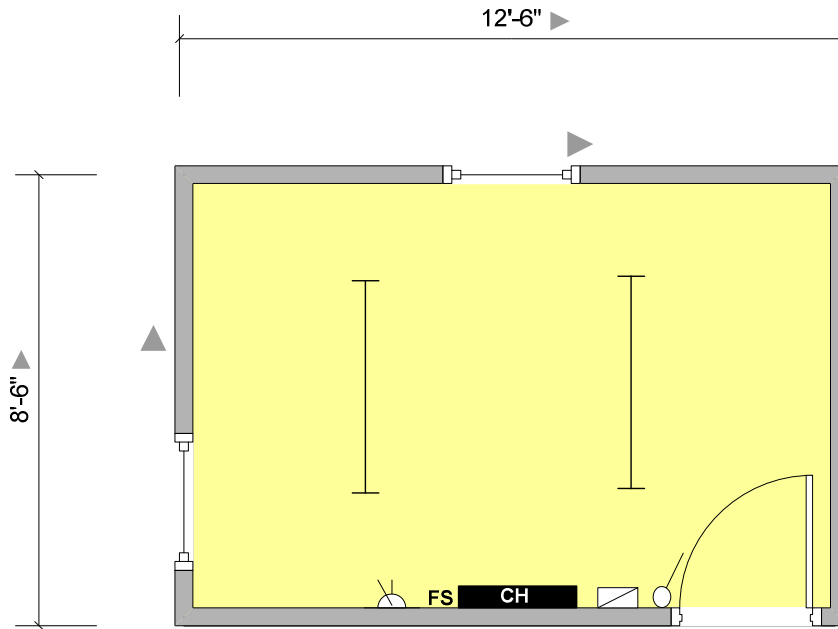

Key			
	Carpet Tiles		Vinyl Flooring
	Florescent Light		Cat 2 Light
	Consumer Unit		Light Switch
	Water Heater		Bulkhead Light
	Single Switch Socket		Double Switch Socket
	Convector Heater		Guarded Tubular Heater
	Fan Heater		Fused Spur
	Kitchen Sink		Worktop
	Double Sink		Urinal
	Hand Basin		Toilet
	Door		Aperture
	Window		Jackleg

Specification:

Doors: 1 no. Single external inward opening door.

Windows: 2 no. Sliding windows with external window guards.

Lighting: 2 no. Fluorescent lights.

Power: 1 no. Double socket

Heating: 1 no. Convector heater

Floor Coverings: Vinyl

Wall Coverings: Painted Steel

Ceiling Coverings: Painted Steel

Other Information