

Ashwell Grange,  
Stroat,  
Chepstow  
Monmouthshire  
NP16 7LS  
Tel (01594) 528224  
Fax (01594) 528211  
[www.reecer.co.uk](http://www.reecer.co.uk)  
email [info@reecer.co.uk](mailto:info@reecer.co.uk)

**Specialist Dealers in the Sale & Purchase of all Portable Buildings and Containers**  
Transport • Storage • Site Work • Refurbishment



## RS 1379

32' x 10' TEXTURE COATED 5 + 2 TOILET BLOCK

Partitioned toilet block to form male toilet facilities complete with five urinals, cubicles and hand basins and with its own separate entrance female toilet facilities with two cubicles and hand basins. Fluorescent lighting, tubular heating and vinyl flooring throughout.

**£3795.00 + VAT Strictly "as is"**

# Unit Information

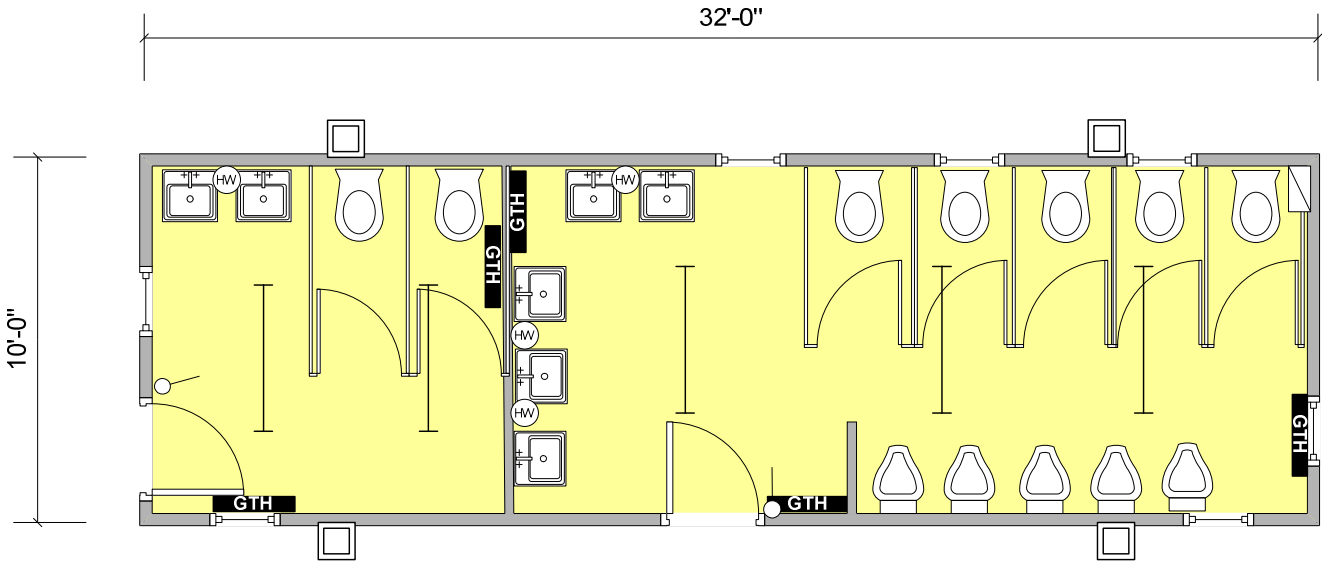

## Key

	Carpet Tiles		Vinyl Flooring
	Florescent Light		Cat 2 Light
	Consumer Unit		Light Switch
	Water Heater		Bulkhead Light
	Single Switch Socket		Double Switch Socket
	Convactor Heater		Guarded Tubular Heater
	Fan Heater		Fused Spur
	Kitchen Sink		Worktop
	Double Sink		Urinal
	Hand Basin		Toilet
	Door		Aperture
	Window		Jackleg

## Specification:

**Doors:** 2 no. External inward opening doors.

**Windows:** 7 no. High level windows.

**Lighting:** 5 no. Fluorescent lights.

**Power:** 6 way Hager consumer unit.

**Heating:** 5 no. Guarded tubular heaters.

**Floor Coverings:** Vinyl

**Wall Coverings:** Plasterboard

**Ceiling Coverings:** Plasterboard

**Other Information** External Finish: Texture Coating