

## **RS1502**

**24' x 9' SECURE ANTI VANDAL UNIT**

Recently painted externally. Open plan office unit with sliding windows and external shutters. Internally consisting of fluorescent lighting, convector heating and vinyl flooring.

**Furniture available on request.**

**£2395.00 + VAT**

## Unit Information

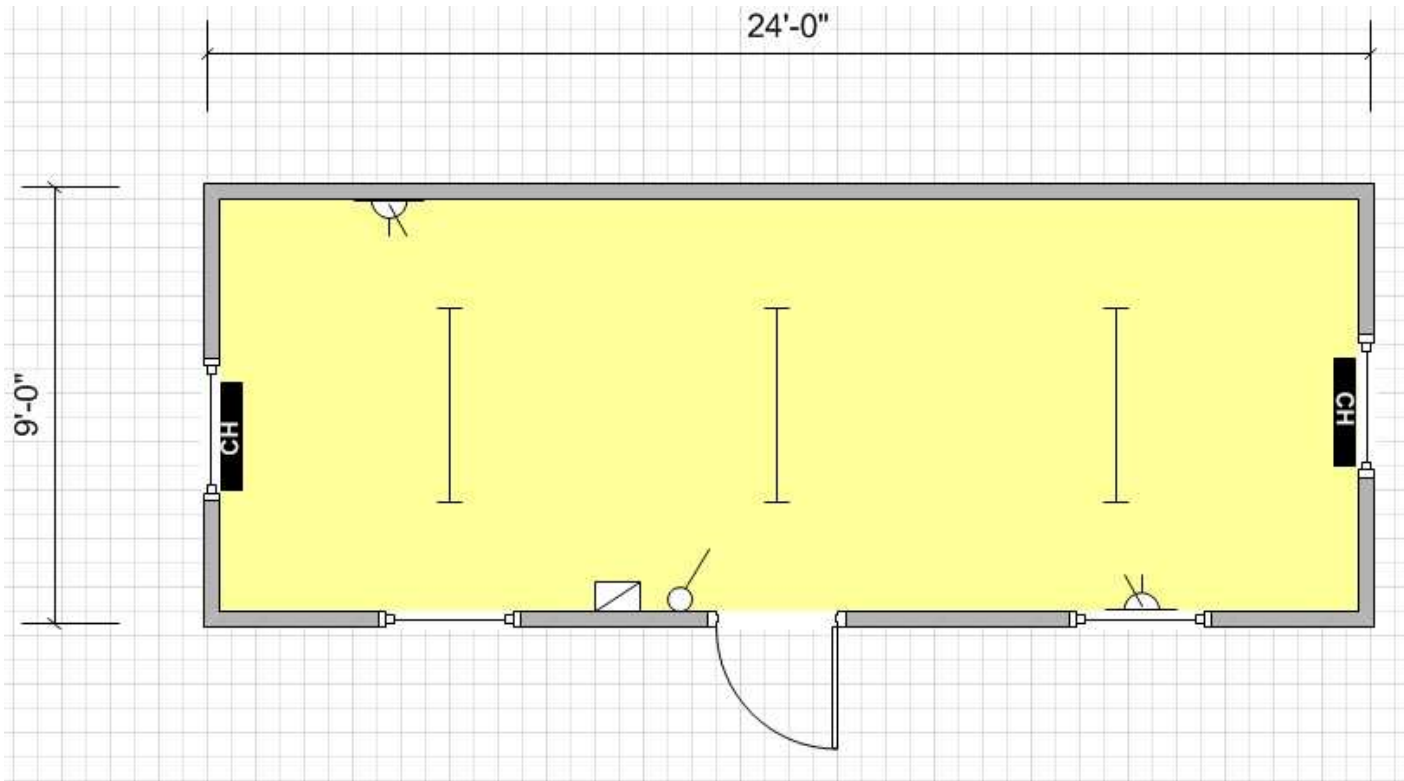

Key			
	Carpet Tiles		Vinyl Flooring
	Florescent Light		Cat 2 Light
	Consumer Unit		Light Switch
	Water Heater		Bulkhead Light
	Single Switch Socket		Double Switch Socket
	Convector Heater		Guarded Tubular Heater
	Fan Heater		Fused Spur
	Kitchen Sink		Worktop
	Double Sink		Urinal
	Hand Basin		Toilet
	Door		Aperture
	Window		Jackleg

## Specification:

**Doors:** 1no. Single external outward opening door.

**Windows:** 4no. Sliding windows with external shutters.

**Lighting:** 3no. Fluorescent lights.

**Power:** 2no. Double sockets.

**Heating:** 2no. Convector heaters.

**Floor Coverings:** Vinyl.

**Wall Coverings:** Ply with a wood effect finish.

**Ceiling Coverings:** Mono white.

**Other Information:**

**Exterior Wall:** Trough Steel