

## RS 1651

21' x 8' ANTI VANDAL CANTEEN WITH JACKLEGS

Excellent quality open plan, secure canteen unit with sliding windows, external shutters and steel multi point locking door. Internally including fluorescent lighting, convector heating, power and vinyl flooring throughout.

**£3395.00 + VAT**

# Unit Information

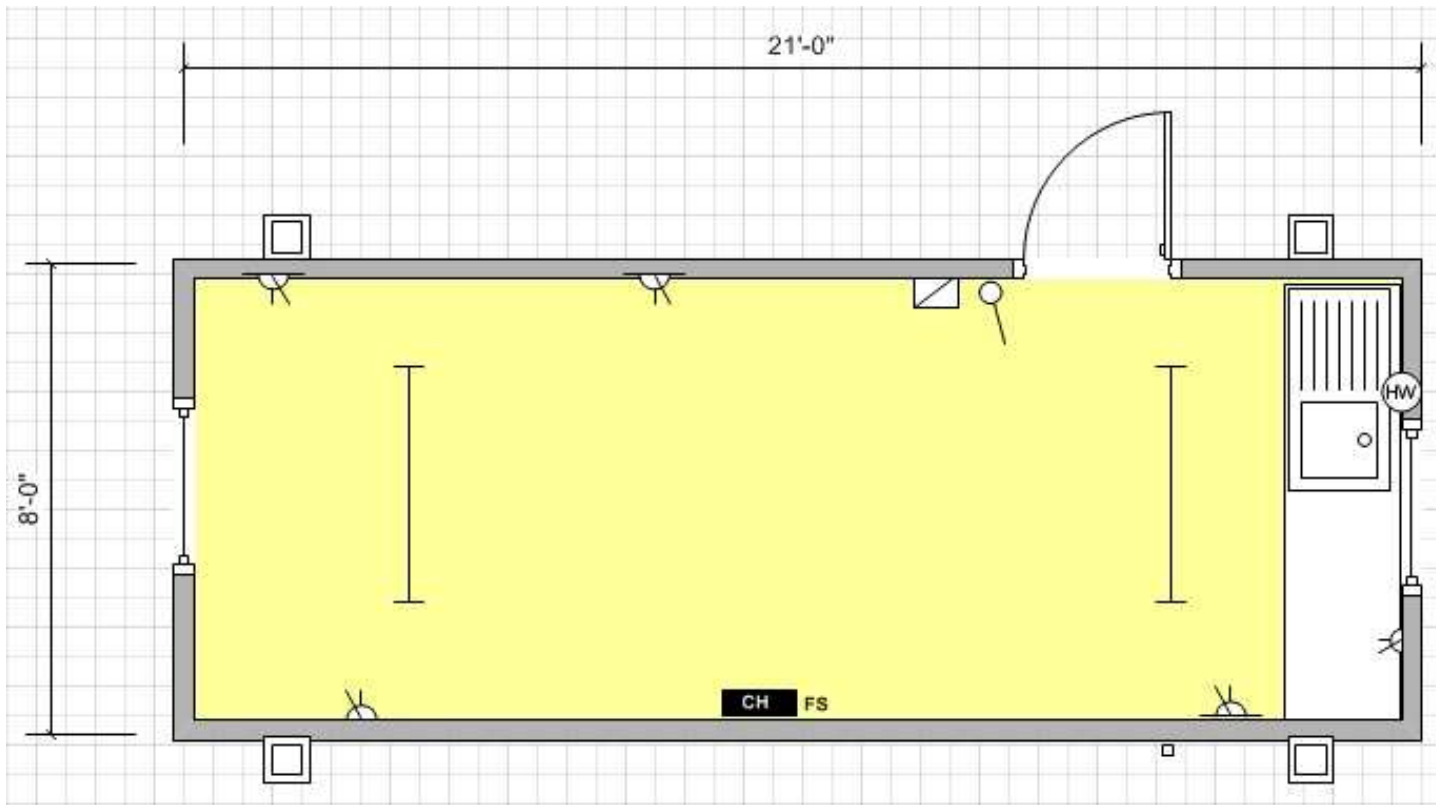

Key			
	Carpet Tiles		Vinyl Flooring
	Florescent Light		Cat 2 Light
	Consumer Unit		Light Switch
	Water Heater		Bulkhead Light
	Single Switch Socket		Double Switch Socket
	Convector Heater		Guarded Tubular Heater
	Fan Heater		Fused Spur
	Kitchen Sink		Worktop
	Double Sink		Urinal
	Hand Basin		Toilet
	Door		Aperture
	Window		Jackleg

## Specification:

**Doors:** 1no. External outward opening steel multi point locking door

**Heating:** 1 no. Convector Heater

**Other Information:** Exterior wall: Trough steel

**Windows:** 2 no. Sliding windows with external shutters

**Floor Coverings:** Vinyl

**Lighting:** 2 no. Fluorescent lights

**Wall Coverings:** Vinyl faced ply

**Power:** 5 no. Double sockets  
1 no. Consumer unit

**Ceiling Coverings:** Mono white