

RS 1652

20' x 8' ANTI VANDAL OFFICE/STORE

Office with sliding window with external shutters, vinyl flooring, convector heating, power and fluorescent lighting.

Store with bare steel walls, plywood flooring and set of double outward opening doors with integral lock.

£3500.00 + VAT

Unit Information

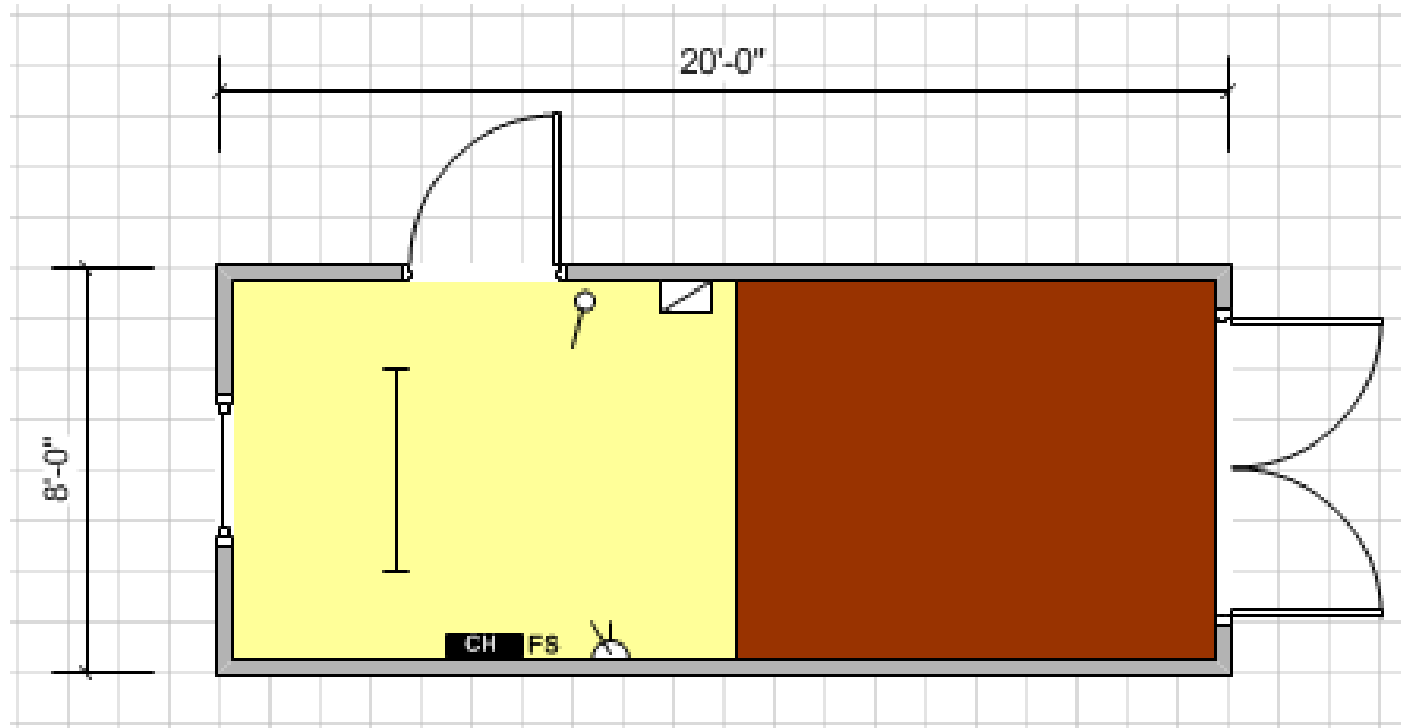

Key			
	Carpet Tiles		Vinyl Flooring
	Florescent Light		Cat 2 Light
	Consumer Unit		Light Switch
	Water Heater		Bulkhead Light
	Single Switch Socket		Double Switch Socket
	Convector Heater		Guarded Tubular Heater
	Fan Heater		Fused Spur
	Kitchen Sink		Worktop
	Double Sink		Urinal
	Hand Basin		Toilet
	Door		Aperture
	Window		Jackleg

Specification:

Doors: 1 no. Set of outward opening external doors.
1 no. External outward opening personnel door.

Windows: 1 no. Sliding window with external shutters.

Lighting: 1 no. Fluorescent light.

Power: 1 no. Consumer unit.
1 no. Double socket.

Heating: 1 no. Convector heater.

Floor Coverings: Office: Vinyl flooring.
Store: Ply wood flooring.

Wall Coverings: Office: Vinyl faced ply.
Store: Bare steel.

Ceiling Coverings: Office: Mono white.
Store: Bare steel.

Other Information: Exterior wall: Trough steel.