

RS 1677

24' x 8' ANTI VANDAL 50 / 50 CANTEEN / STORE

50 / 50 unit to form a store with ply flooring, fluorescent lighting, bare steel walls except the back wall which is finished with ply and secure double doors with integral lock. Separate canteen area consisting of vinyl flooring, convactor heating, power and fluorescent lighting.

£2995.00 + VAT

Unit Information

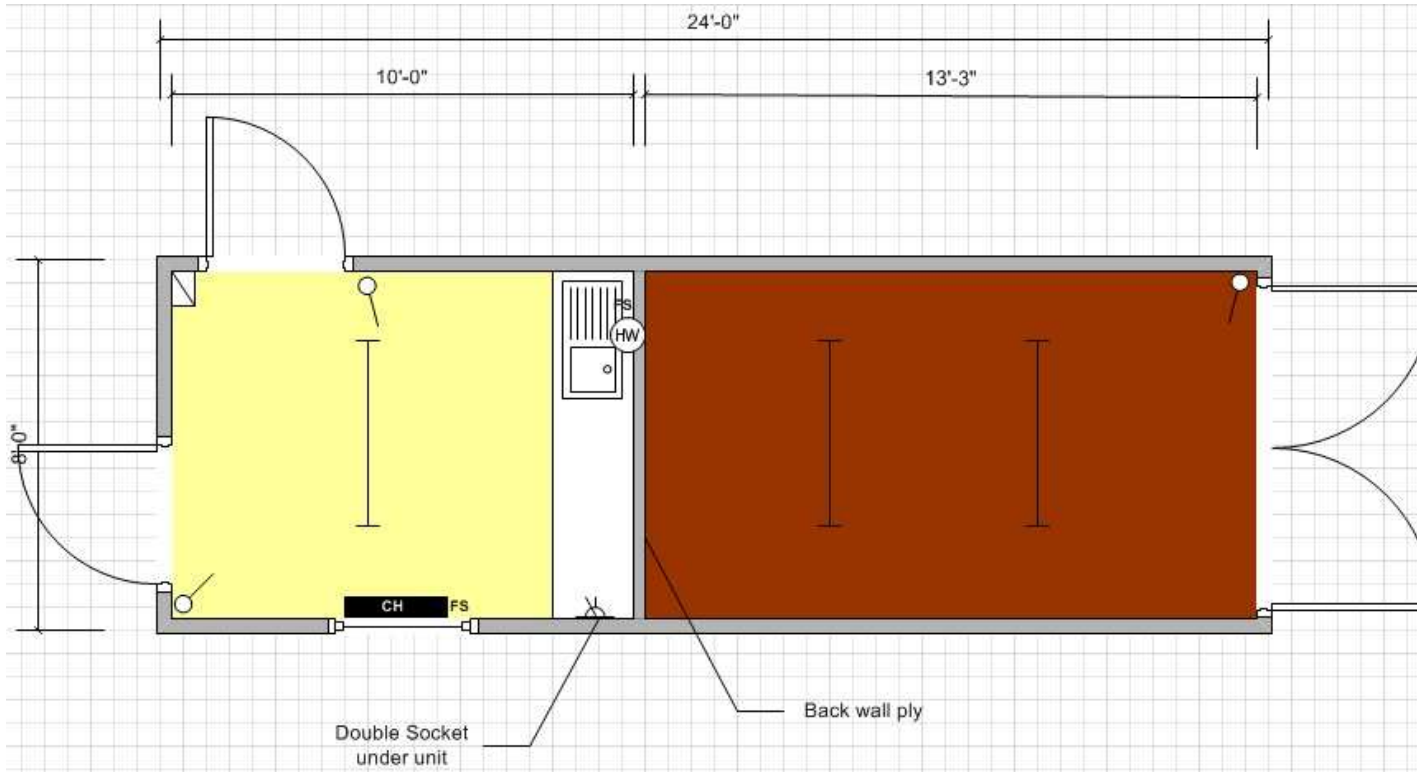

Key

	Carpet Tiles		Vinyl Flooring
	Florescent Light		Cat 2 Light
	Consumer Unit		Light Switch
	Water Heater		Bulkhead Light
	Single Switch Socket		Double Switch Socket
	Convactor Heater		Guarded Tubular Heater
	Fan Heater		Fused Spur
	Kitchen Sink		Worktop
	Double Sink		Urinal
	Hand Basin		Toilet
	Door		Aperture
	Window		Jackleg

Doors: 1 no. Set of double doors with integral lock to store.
2 no. external outward opening doors to canteen.

Windows: 1 no. Sliding window with external shutters.

Lighting: 3 no. Fluorescent Lights.

Power: 1 no. Double socket.
1 no. Consumer Unit.

Heating: 1 no. Convactor heater.

Floor Coverings: Canteen: Vinyl.
Store: Ply.

Wall Coverings: Canteen: Vinyl faced ply.
Store: Bare steel except back wall: Ply.

Ceiling Coverings: Canteen: Mono white.
Store: Bare Steel.

Other Information:

External finish: Trough steel