

RS 1694/1695/1843

Choice of three available

12' x 7'6" ANTI VANDAL MOBILE CANTEEN

Mobile canteen with sliding windows and external shutters. Unit internally consists of a double base unit with sink, over sink water heater and worktop, bench style seating area with underneath storage facilities. Fluorescent lighting, convector heating and vinyl flooring.

£4995.00 + VAT

Unit Information

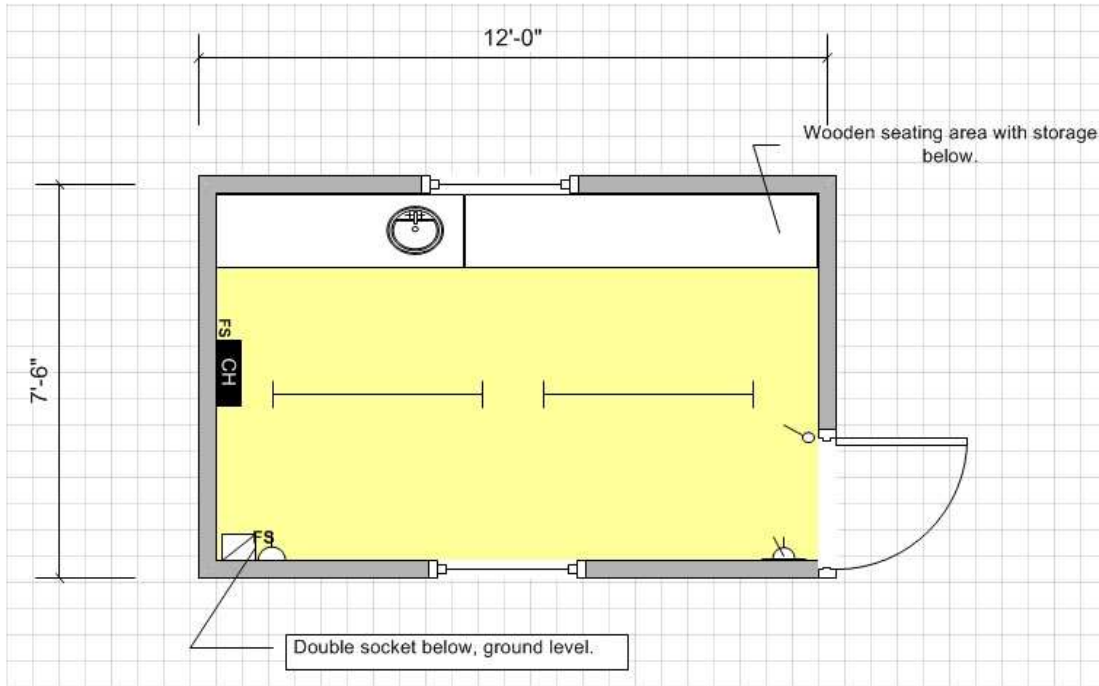

Key			
	Carpet Tiles		Vinyl Flooring
	Florescent Light		Cat 2 Light
	Consumer Unit		Light Switch
	Water Heater		Bulkhead Light
	Single Switch Socket		Double Switch Socket
	Convector Heater		Guarded Tubular Heater
	Fan Heater		Fused Spur
	Kitchen Sink		Worktop
	Double Sink		Urinal
	Hand Basin		Toilet
	Door		Aperture
	Window		Jackleg

Specification:

Doors: 1 no. Outward opening external door.

Windows: 2 no sliding windows with external shutters.

Lighting: 2 no. Fluorescent Lights

Power: 2 no. Double sockets
1 no. Single socket

Heating: 1 no. Convector Heating

Floor Coverings: Vinyl

Wall Coverings: Vinyl faced ply.

Ceiling Coverings:

Other Information:

Canteen with 1no. double base unit.

1no Bench seating area with storage below.

External finish: Flat steel