



RS1751

24' x 9' PLASTISOL STEEL JACKLEG OFFICE

RECENTLY REFURBISHED plastisol steel jackleg office, complete with convector heating, fluorescent lighting, top opening vent windows and insulated vinyl flooring.

£4695.00 + VAT

Unit Information

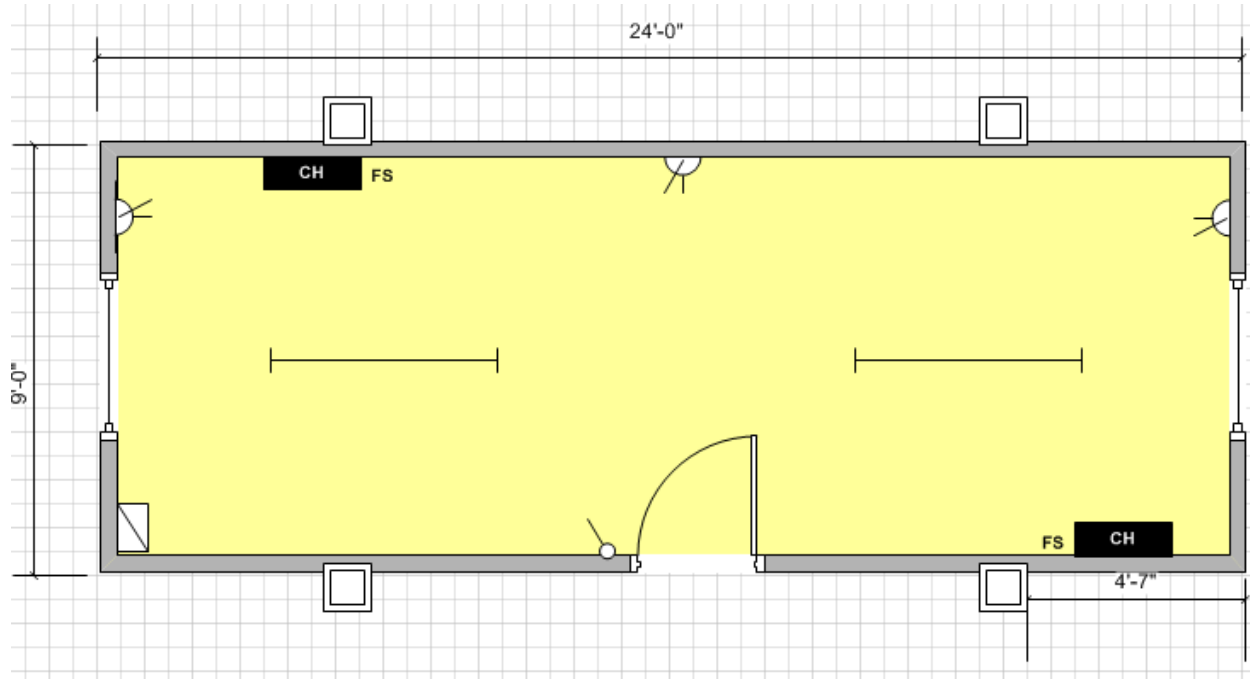

Key

	Carpet Tiles		Vinyl Flooring
	Florescent Light		Cat 2 Light
	Consumer Unit		Light Switch
	Water Heater		Bulkhead Light
	Single Switch Socket		Double Switch Socket
	Convector Heater		Guarded Tubular Heater
	Fan Heater		Fused Spur
	Kitchen Sink		Worktop
	Double Sink		Urinal
	Hand Basin		Toilet
	Door		Aperture
	Window		Jackleg

Doors: 1 no. External inward opening door.

Heating: 2 no. Convector heaters.

Windows: 2 no. Top opening vent windows.

Floor Coverings: Vinyl.

Lighting: 2 no. Fluorescent lights.

Wall Coverings: Vinyl faced ply.

Power: 3 no. Double sockets.
1 no. Consumer unit.

Ceiling Coverings: Vinyl faced ply.

Other Information:

External finish: Plastisol steel.