



RS 1781

20' x 9' PLASTISOL STEEL PARTITIONED SKID UNIT

Good condition partitioned unit to form a canteen with fixed tables and seating. Male WC facilities, each area with its own entrance. The unit internally consists of lighting, heating and radius sliding windows throughout.

£3895.00 + VAT

Unit Information

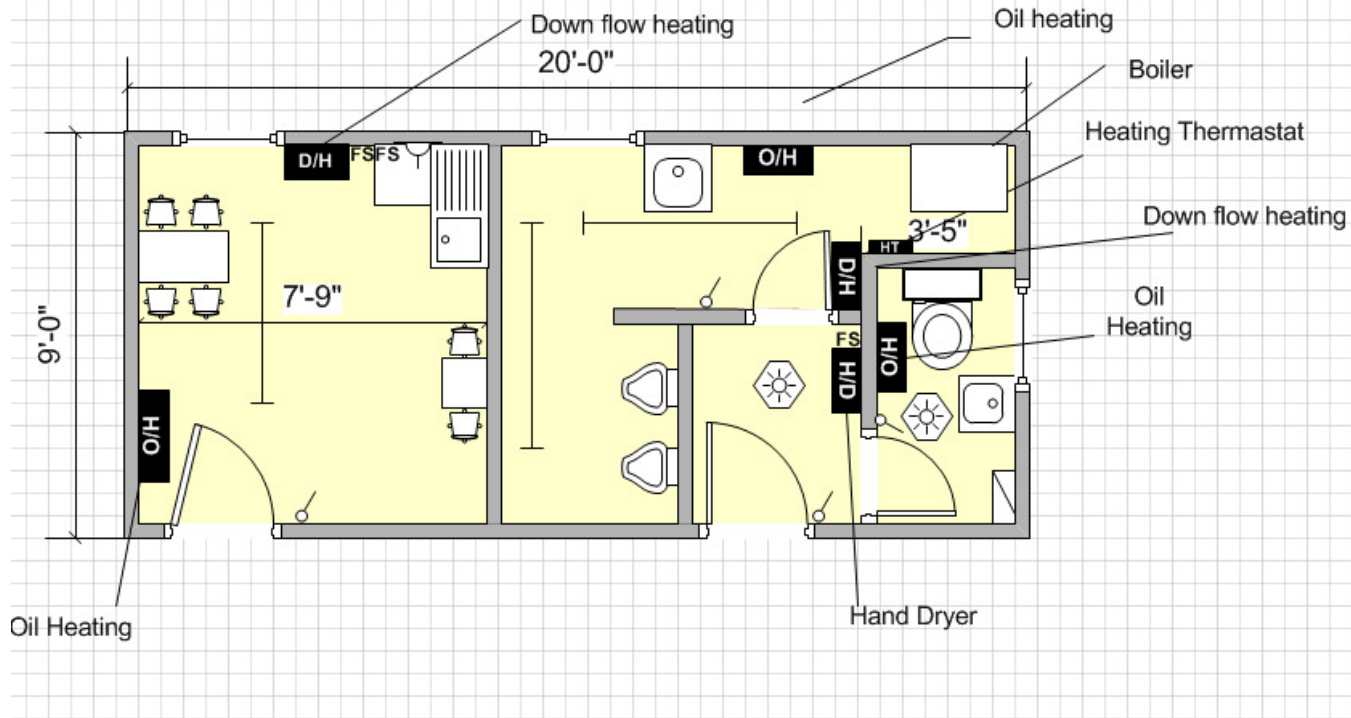

Key			
	Carpet Tiles		Vinyl Flooring
	Florescent Light		Cat 2 Light
	Consumer Unit		Light Switch
	Water Heater		Bulkhead Light
	Single Switch Socket		Double Switch Socket
	Convactor Heater		Guarded Tubular Heater
	Fan Heater		Fused Spur
	Kitchen Sink		Worktop
	Double Sink		Urinal
	Hand Basin		Toilet
	Door		Aperture
	Window		Jackleg

Doors: 2 no. External inward opening doors.

2 no. Internal doors.

Windows: 3 no. Radius sliding window.

Lighting: 3 no. Fluorescent lights.

2 no. Moisture resistant lights.

Power: 1 no. Single socket.

1 no. Consumer unit.

Heating: 2 no. Down flow heaters.

2 no. Oil heaters.

1 no. Hand dryer.

Floor Coverings: Vinyl.

Wall Coverings: Mainly painted steel.

Ceiling Coverings: Painted bare steel.

Other Information:

External finish: Plastisol steel.

Boiler, hand dryer and heating thermostat as detailed in the drawing.

Fixed tables and seating.