



RS1810

24' x 10' PLASTISOL STEEL JACKLEG

Plastisol steel unit partitioned to form sleeping area with carpet flooring, convector heating, fluorescent lighting and top opening vent windows with external shutters, Central WC / Shower area complete with moisture resistant lighting, high level window and vinyl flooring. Also canteen / Office room consisting of worktops, sink and water heater, top opening vent window with external shutter and vinyl flooring.

£2495.00 + VAT

Unit Information

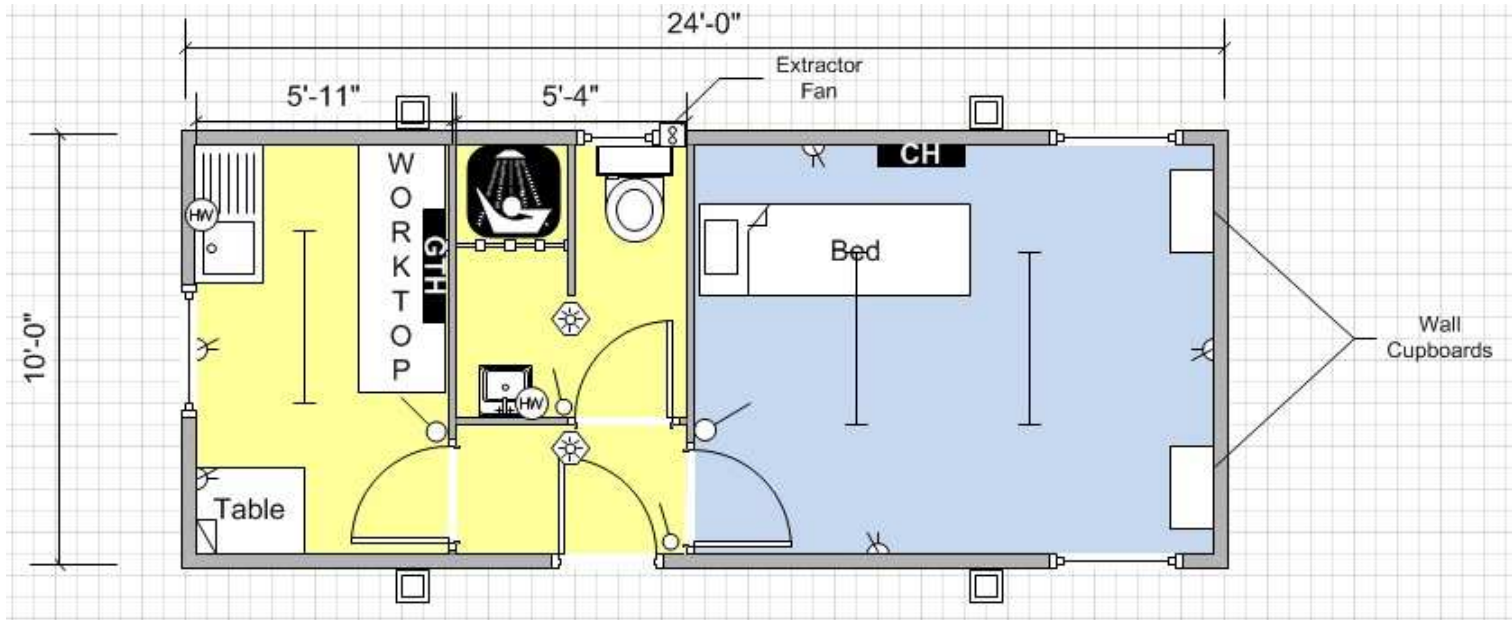

Key			
	Carpet Tiles		Vinyl Flooring
	Florescent Light		Cat 2 Light
	Consumer Unit		Light Switch
	Water Heater		Bulkhead Light
	Single Switch Socket		Double Switch Socket
	Convactor Heater		Guarded Tubular Heater
	Fan Heater		Fused Spur
	Kitchen Sink		Worktop
	Double Sink		Urinal
	Hand Basin		Toilet
	Door		Aperture
	Window		Jackleg

Doors: 1 no. External inward opening
3 no. Internal doors

Heating: 1 no. Guarded tubular heaters.
1 no. Convactor heater
1 no. Hand wash water heater
1 no. Over sink water heater.

Other Information:

External finish: Plastisol steel.

Windows: 3 no. Top opening vent windows
With external shutters
1 no. High level window

Floor Coverings: Vinyl to WC/Shower & Kitchen
Carpet to the sleeping area

Lighting: 3 no. Fluorescent lights.
2 no. Moisture resistant lights.

Wall Coverings: Plasterboard

Power: 1 no. consumer unit.
5 no. Double sockets

Ceiling Coverings: Plasterboard

Complete with
1no. set of jacklegs.