



RS 1821

20' x 9' PLASTISOL STEEL JACKLEG

GOOD CONDITION open plan canteen complete with convector heating, fluorescent lighting, double sockets, vinyl flooring and Plastisol Steel throughout and top opening vent windows with external slide down shutters.

£2895.00 + VAT

Unit Information

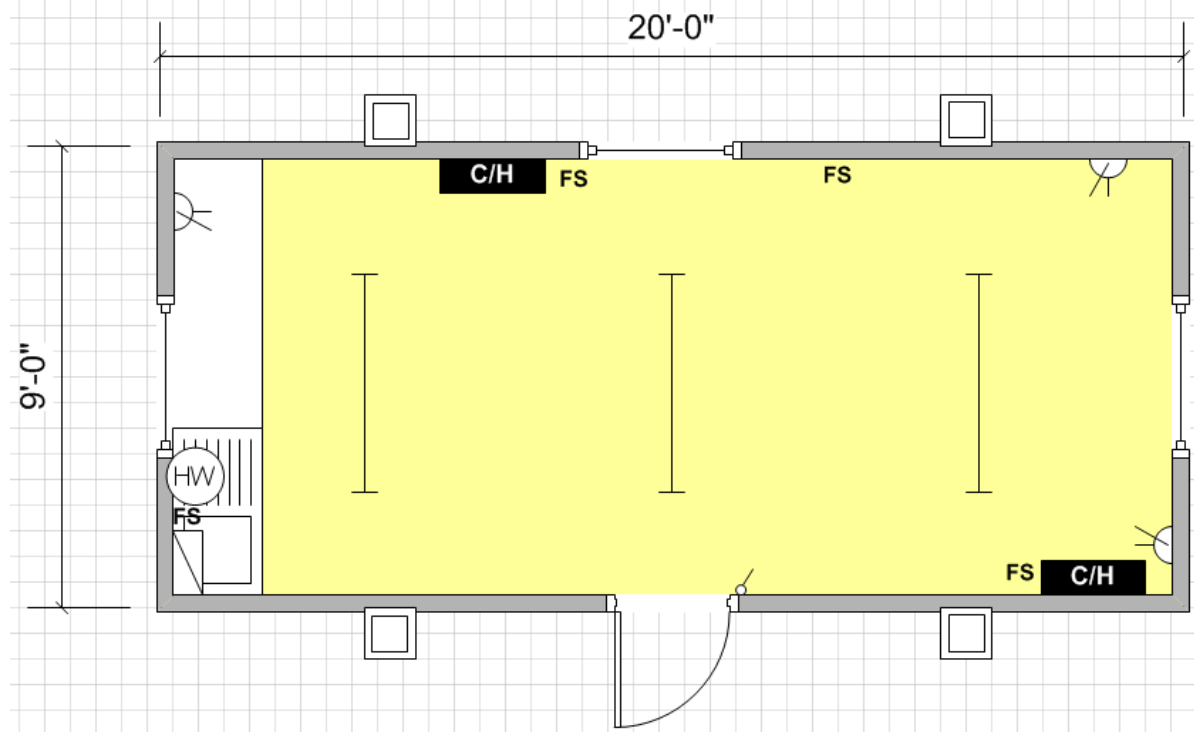

Key			
	Carpet Tiles		Vinyl Flooring
	Florescent Light		Cat 2 Light
	Consumer Unit		Light Switch
	Water Heater		Bulkhead Light
	Single Switch Socket		Double Switch Socket
	Convector Heater		Guarded Tubular Heater
	Fan Heater		Fused Spur
	Kitchen Sink		Worktop
	Double Sink		Urinal
	Hand Basin		Toilet
	Door		Aperture
	Window		Jackleg

Specification:

Doors: 1 no. External outward opening door with top & bottom locking system.

Windows: 3 no. Top opening vent windows with external slide down shutters..

Lighting: 3 no. Moisture resistant fluorescent strip lights.

Power: 1 no. Consumer unit.
3 no. Double sockets

Heating: 2 no. Convector heaters.
1 no. Water heater.

Floor Coverings: Vinyl.

Wall Coverings: Plastisol Steel.

Ceiling Coverings: Plastisol Steel.

Other Information: **Exterior finish:** Plastisol Steel.

Complete with jacklegs.