



RS1830

10' x 10' PLASTISOL SKID UNIT

Refurbished unit to form drying room, ideal for any sporting facilities. All round fixed benching and 2no. high level windows with external guards for extra security. Moisture resistant lighting, vinyl flooring and down flow heating fitted internally.

£1595.00 + VAT

Unit Information

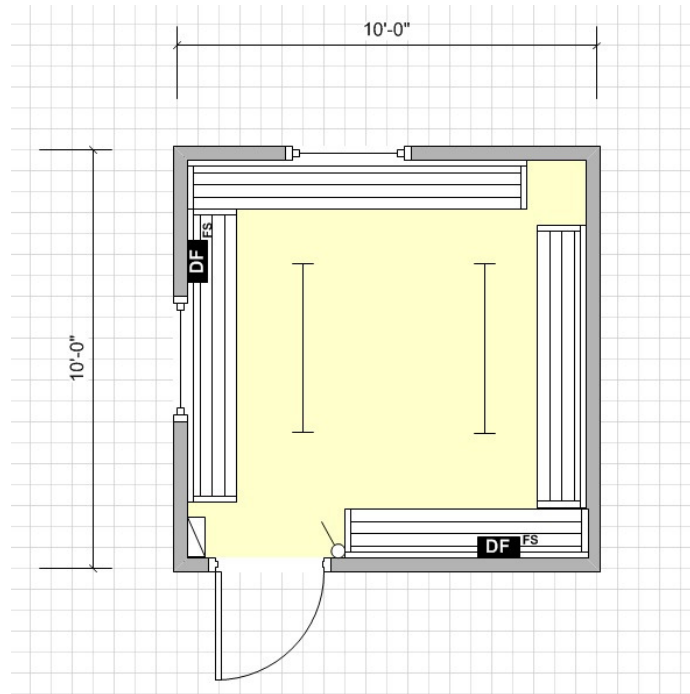

Specification:

Doors: 1 no. Single external outward opening door with top and bottom locking system.

Windows: 2 no. Top hung high level windows with external guards.

Lighting: 2 no. Moisture resistant lights.

Power: 1no. Consumer unit.

Heating: 2 no. Down flow heaters.

Floor Coverings: Vinyl flooring.

Wall Coverings: Plastisol steel & vinyl faced ply.

Ceiling Coverings: Plastisol steel.

Key			
	Carpet Tiles		Vinyl Flooring
	Florescent Light		Cat 2 Light
	Consumer Unit		Light Switch
	Water Heater		Bulkhead Light
	Single Switch Socket		Double Switch Socket
	Convector Heater		Guarded Tubular Heater
	Fan Heater		Fused Spur
	Kitchen Sink		Worktop
	Double Sink		Urinal
	Hand Basin		Toilet
	Door		Aperture
	Window		Jackleg

External Finish: Plastisol steel.

Additional: All round fixed benching.
Two sets of coat hooks.