

## RS 1834

32' x 10' PLASTISOL STEEL JACKLEG

PLASTISOL STEEL unit partitioned to form office/kitchen and drying room complete with convector heating, double sockets, lighting, vinyl flooring and benching to the drying room.

**£4495.00 + VAT**  
**As Is**

Canteen facilities can be fitted at an additional price, please call the sales team for details.

# Unit Information

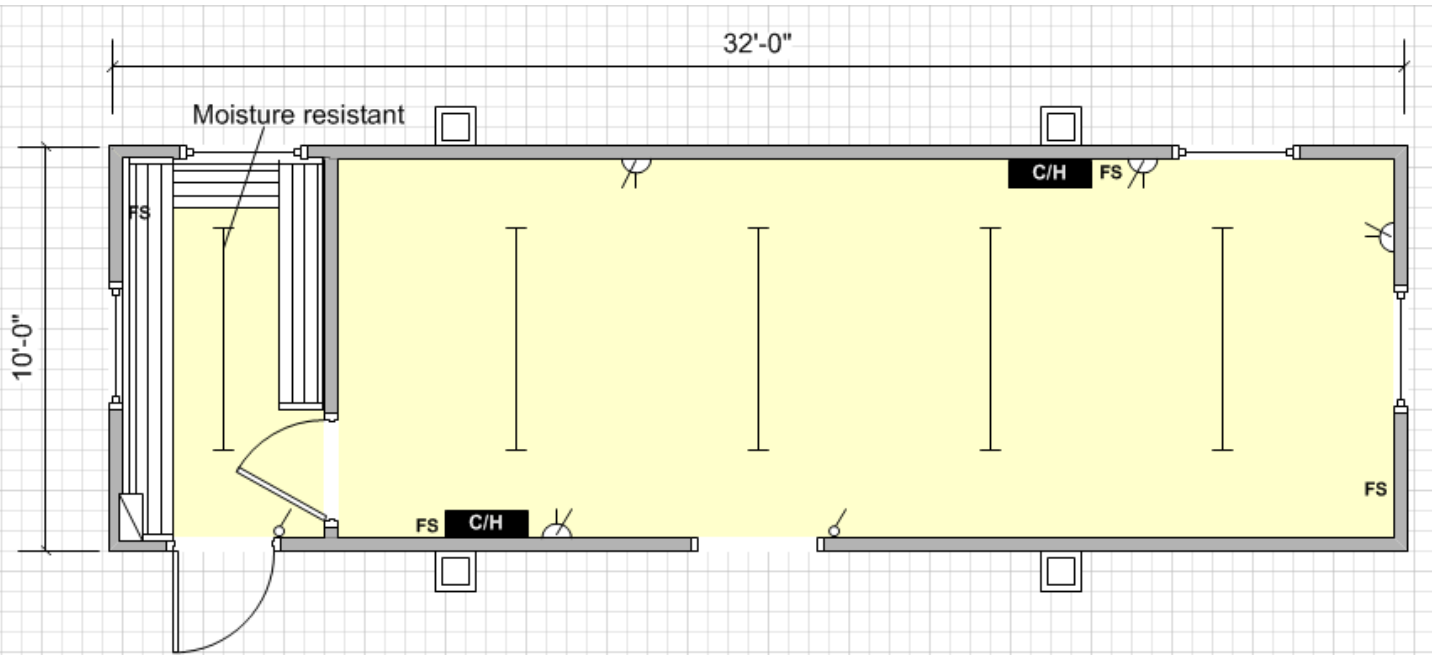

Key			
	Carpet Tiles		Vinyl Flooring
	Florescent Light		Cat 2 Light
	Consumer Unit		Light Switch
	Water Heater		Bulkhead Light
	Single Switch Socket		Double Switch Socket
	Convector Heater		Guarded Tubular Heater
	Fan Heater		Fused Spur
	Kitchen Sink		Worktop
	Double Sink		Urinal
	Hand Basin		Toilet
	Door		Aperture
	Window		Jackleg

## Specification:

**Doors:** 1 no. External aperture.  
 1 no. External outward opening door.  
 1 no. Internal door.

**Windows:** 1 no. Top opening vent window with external slide down shutter.  
 1 no. Top opening vent window.  
 2 no. High level windows.

**Lighting:** 4 no. Fluorescent strip lights.  
 1 no. Moisture resistant fluorescent strip light.

**Power:** 4 no. Double Sockets.  
 1 no. Consumer unit.

**Heating:** 2 no. Convective heaters.

**Floor Coverings:** Vinyl.

**Wall Coverings:** Plastisol steel.  
 Partition: Vinyl faced ply.

**Ceiling Coverings:** Plastisol Steel.

**Other Information:** Exterior finish: Plastisol steel.

Complete with jacklegs and benching.