

RS 1836

32' x 10' PLASTISOL STEEL JACKLEG

PLASTISOL STEEL partly refurbished jackleg partitioned to form a toilet and canteen area. The unit consists of high level windows, Kitchen area, double sockets, convactor heaters, fluorescent and moisture resistant lighting, vinyl flooring and vinyl faced ply walls throughout.

£4995.00 + VAT

Unit Information

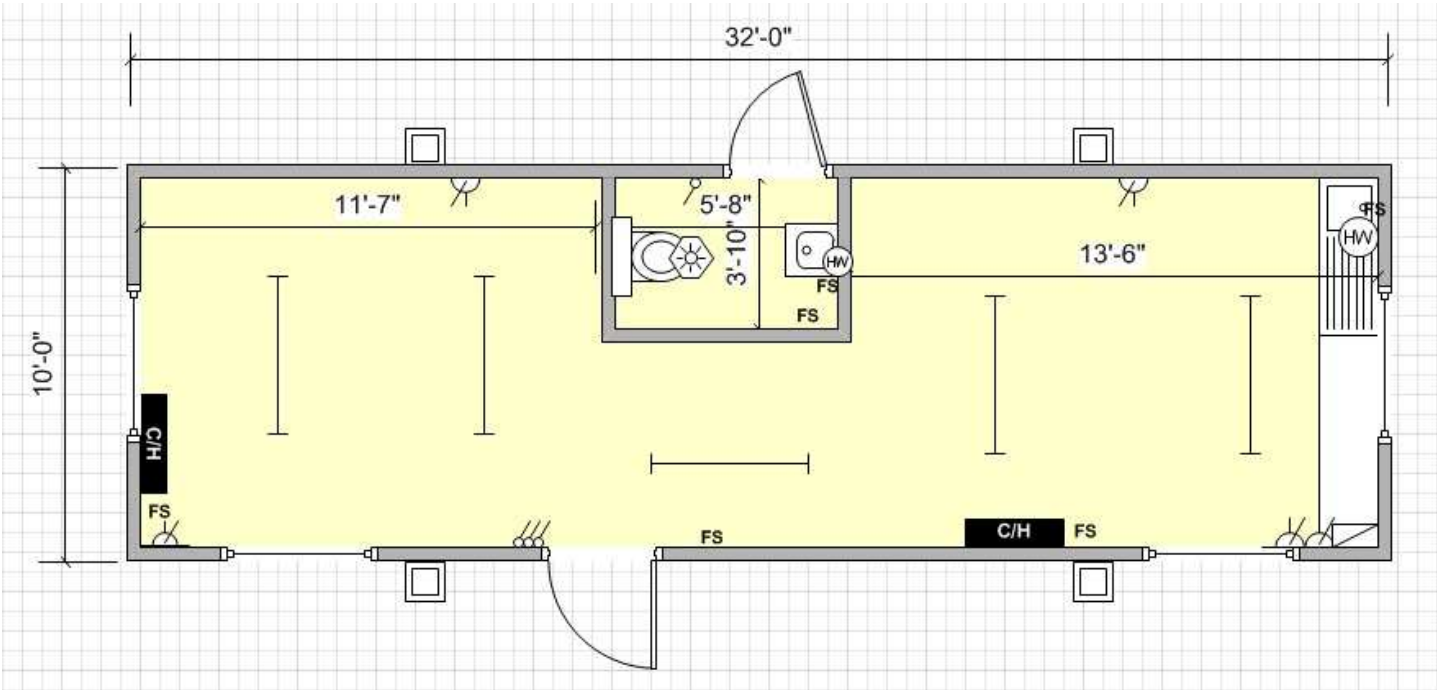

Key			
	Carpet Tiles		Vinyl Flooring
	Florescent Light		Cat 2 Light
	Consumer Unit		Light Switch
	Water Heater		Bulkhead Light
	Single Switch Socket		Double Switch Socket
	Convector Heater		Guarded Tubular Heater
	Fan Heater		Fused Spur
	Kitchen Sink		Worktop
	Double Sink		Urinal
	Hand Basin		Toilet
	Door		Aperture
	Window		Jackleg

Specification:

Doors: 2 no. External outward opening doors.

Windows: 4 no. Top opening vent windows.

Lighting: 5 no. Fluorescent strip lights.
1 no. Moisture resistant light.

Power: 5 no. Double Sockets.
1 no. Consumer unit.

Heating: 2 no. Convector heaters.

Floor Coverings: Vinyl.

Wall Coverings: Vinyl faced ply.

Ceiling Coverings: Vinyl faced ply.

Other Information: **Exterior finish:** Plastisol Steel.

Complete with jacklegs.