



RS1842

24' x 8' Anti Vandal

Partitioned unit to form canteen area and drying room with vinyl flooring, fluorescent lighting and convector heating throughout.

£3795.00 + VAT

Unit Information

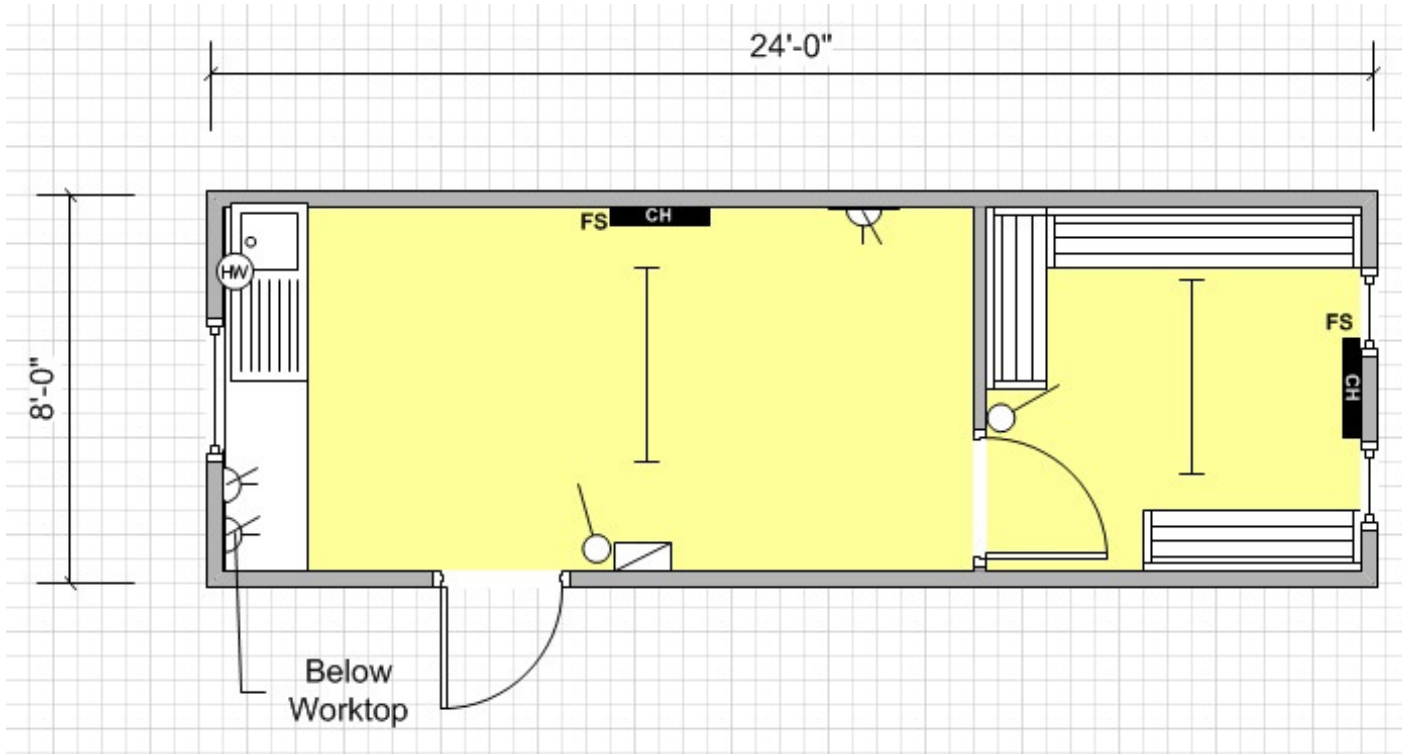

Key			
	Carpet Tiles		Vinyl Flooring
	Florescent Light		Cat 2 Light
	Consumer Unit		Light Switch
	Water Heater		Bulkhead Light
	Single Switch Socket		Double Switch Socket
	Convector Heater		Guarded Tubular Heater
	Fan Heater		Fused Spur
	Kitchen Sink		Worktop
	Double Sink		Urinal
	Hand Basin		Toilet
	Door		Aperture
	Window		Jackleg

Specification:

Doors: 1 no. Single external outward opening door.

Windows: 1 no. Sliding window with external shutters in the canteen.
2 no. High level windows with external window guards in the drying room.

Lighting: 2 no. Fluorescent Lights.

Power: 3 no. Double sockets.
Square D 5 way consumer unit.

Heating: 2 no. Convector heaters.

Floor Coverings: Vinyl.

Wall Coverings: E G B 2001 shade.

Ceiling Coverings: Mono White.

Other Information