



RS1893

12' x 10' REFURBISHED PLASTISOL STEEL SKID CANTEEN

Plastisol steel skid canteen. Internally complete with convector heating, fluorescent strip lighting, double sockets, top opening vent windows, part vinyl faced ply/ part Plastisol steel walls and vinyl flooring throughout.

£1995.00 + VAT

Unit Information

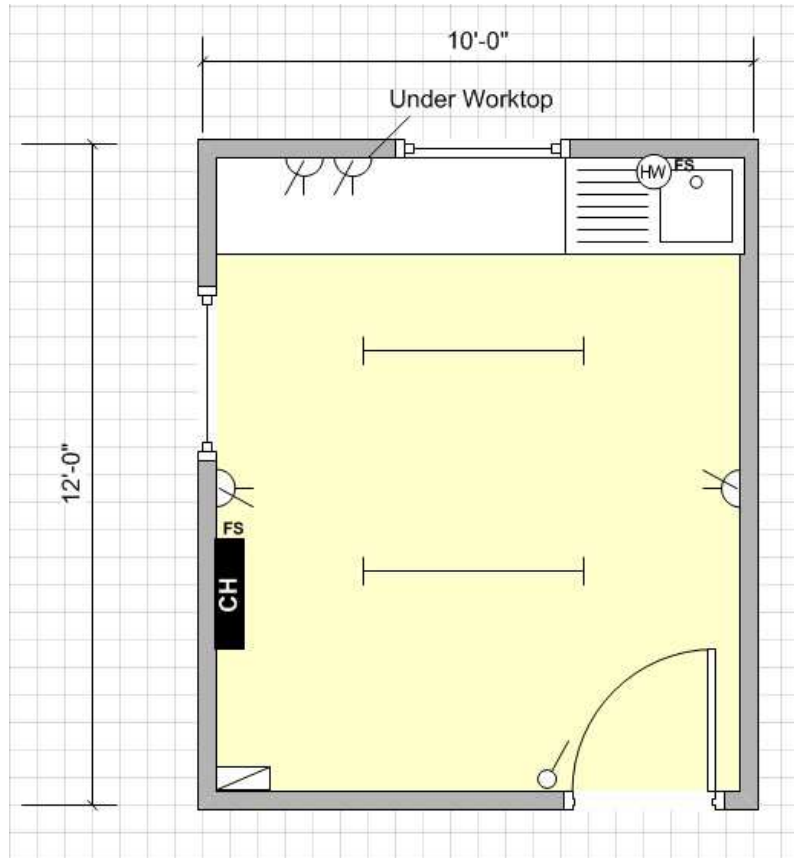

Key

	Carpet Tiles		Vinyl Flooring
	Florescent Light		Cat 2 Light
	Consumer Unit		Light Switch
	Water Heater		Bulkhead Light
	Single Switch Socket		Double Switch Socket
	Convector Heater		Guarded Tubular Heater
	Fan Heater		Fused Spur
	Kitchen Sink		Worktop
	Double Sink		Urinal
	Hand Basin		Toilet
	Door		Aperture
	Window		Jackleg

Specification:

Doors: 1 no. Single external inward opening door.

Windows: 2 no. Top opening vent windows with external shutters.

Lighting: 2 no. Fluorescent strip lights.

Power: 4 no. Double sockets.

Heaters: 1 no. Convector heater.

Floor Coverings: Vinyl.

Wall Coverings: Vinyl faced ply.
Plastisol steel.

Ceiling Coverings: Plastisol steel.

External Finish: Plastisol steel.