

RS 1897

32' x 10' Anti Vandal Office.

Trough Steel Anti Vandal unit partitioned to form two offices and a hallway. The unit consists internally of lighting, convector heating, vinyl faced ply walls, sliding windows, vinyl flooring and convector heating throughout.

£3395.00 + VAT

Unit Information

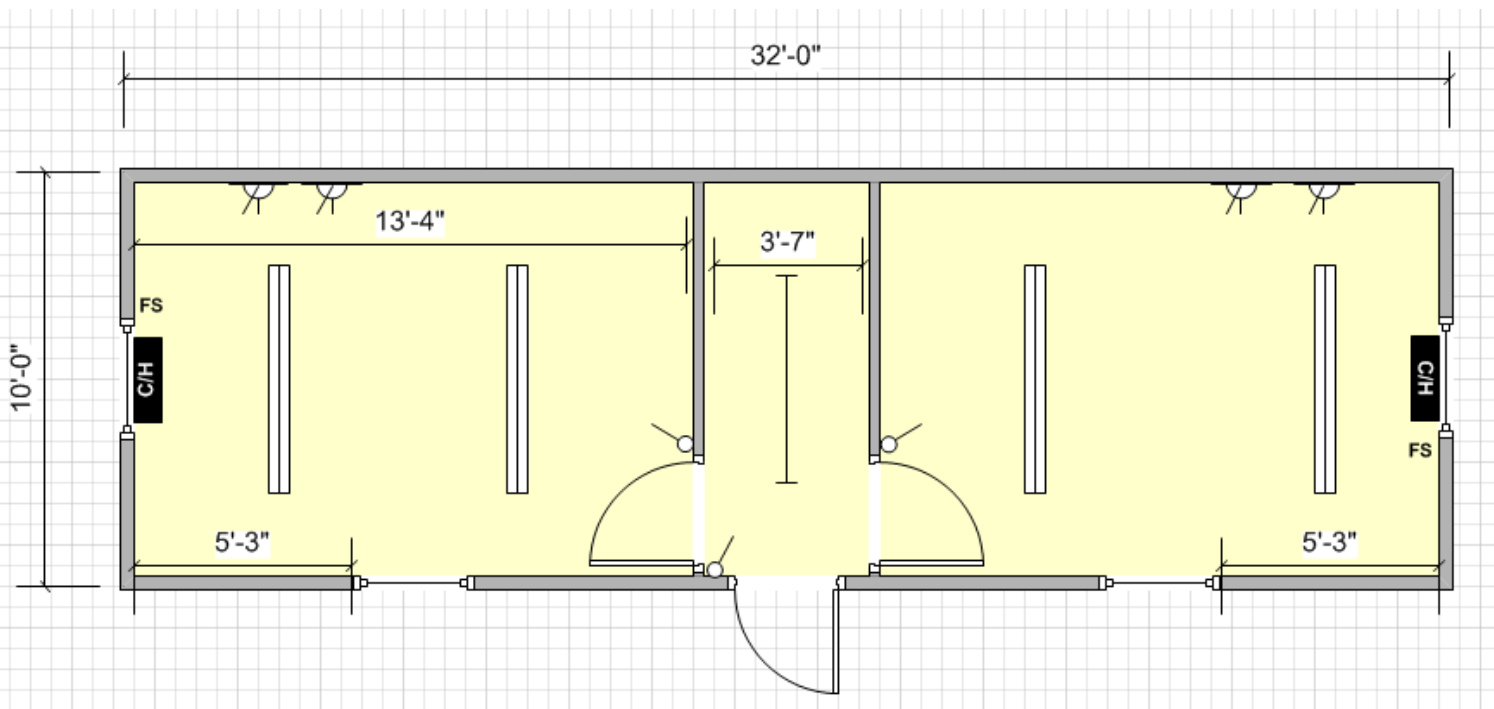

Key			
	Carpet Tiles		Vinyl Flooring
	Florescent Light		Cat 2 Light
	Consumer Unit		Light Switch
	Water Heater		Bulkhead Light
	Single Switch Socket		Double Switch Socket
	Convector Heater		Guarded Tubular Heater
	Fan Heater		Fused Spur
	Kitchen Sink		Worktop
	Double Sink		Urinal
	Hand Basin		Toilet
	Door		Aperture
	Window		Jackleg

Specification:

Doors: 1 no. External outward opening door.
2 no. Internal doors.

Windows: 4 no. Sliding windows.

Lighting: 4 no. Single fluorescent strip lights with Cat 2 lighting.
1 no. Fluorescent strip light..

Power: 4 no. Double Sockets.
1 no. Consumer unit.

Heating: 2 no. Convector heaters.

Floor Coverings: Vinyl.

Wall Coverings: Vinyl faced ply.

Ceiling Coverings: Vinyl faced ply.

Other Information: **Exterior finish:** Plastisol Steel.

Complete with jacklegs.